



## ECO-CITY IS A PRODUCT OF URBANIZATION

Berdikulov Azamat,

Shoboeva Rukhshona,

Teachers of Samarkand State Institute of Architecture and Construction,

Republic of Uzbekistan, Samarkand

E-mail: djfmfarruh@mail.ru

### Annotation

Small towns sprang up around a big city and merged with big cities, and an urban agglomeration was formed. In developed countries, agglomeration processes are rampant, and the aggregation of these agglomerations creates megacities. Given these processes, it is possible to assume that Uzbekistan will continue to develop, and over the years, our densely populated cities will face similar expansion. Therefore, the idea of creating a residential area in the city of Shakhrisabz in Kashkadarya region was born.

**Keywords:** agglomeration, urbanization, urban planning, functional solution, area.

Our Uzbekistan is developing rapidly. At the same time, population growth is driving demand for new jobs. At the same time, construction is being carried out in our capital and regions in various directions. Business centers, cultural centers, large and small enterprises. The construction of these organizations will ensure the development of our country and the activities of its people, and will lay the foundation for a better life. But all of these buildings take up a lot of space in the city, consume too many people and, as a result, lead to the urbanization of the city. The process of urbanization is associated with the growth of cities and the formation of urban architecture, the natural growth of the urban population, the administrative annexation of suburban areas to the city, and the acquisition of urban status of rural settlements. Small towns sprang up around the big city, merged with the big cities, and an urban agglomeration was formed. In developed countries, agglomeration processes are in full swing, and the aggregation of these agglomerations is creating megacities. Given these processes, it can be assumed that Uzbekistan will continue to develop, and over the years, our densely populated cities will face similar expansion. Therefore, the idea of creating a residential area in the city of Shakhrisabz, located in Kashkadarya region, was born.

Various blue trees are planted for the residents of this area. Each house is given a plot of land in the garden, and the owners of this house plant a kind of fruit based on the rules of gardening.

The transportation network in the area is very simple and convenient. I took the sidewalks outside the complex. This, in turn, protects the population from danger and avoids any noise. The courtyard is easily accessible through the open-plan houses on the first floor.



The engineering networks of the area were also constructed in accordance with the requirements. The cables of the power lines were laid directly along the side sheaths. The entrance to the gas supply pipeline was through the roof of the building. Water and sewage networks, in accordance with the norms, the entrance to the heating network and water pipes, as well as the outlet of the sewer were passed mainly through the side of the building. When we do such projects, we need to follow all the above rules and regulations. The solid location of each building on the ground is first and foremost a matter of choosing the right location, making sure that the design is flawless, and taking into account the precautionary measures during construction. The fact that the building is located on the ground in accordance with the sanitary and hygienic requirements will be the basis for its further public service. Evacuation work in the building and the ability to prevent the risk of fire is an important rule, first of all, as an event involving human life.

It is known that the process of meeting people's needs related to life, their living, raising children, education, recreation, morale, health, trade and other household services living parts.

Nowadays, the boundaries of the concept of housing have expanded considerably, and it now includes a full set of service organizations that are necessary for the population. Today, the conditions for the creation of comfortable living conditions in the home are combined with the conditions for a high level of meeting the socio-cultural and domestic needs of the population in residential areas. Creating such a comfortable living environment for the population on such a large scale requires the integration of housing with various social service organizations. The main link in the formation of the social and structural structure of the population of the cities of the Republic is the integral connection of housing with social service organizations.

One of the main rules in the integral connection of housing with social service organizations is to bring them closer to housing, depending on the speed of use of service organizations, that is, the need for the population to participate in which organization is faster and more efficient. prog.

One of the main rules in the integral connection of housing with social service organizations is to bring them closer to housing, depending on the speed of use of service organizations, that is, the need for the population to participate in which organization is faster and more efficient. if there is a program, that organization should be placed so close to the home. On the contrary, the range of services of organizations that use less population will be wider. This social demand, which underlies modern urban planning, requires service organizations to be grouped according to the speed of their use by the population.

The current research summarizes the experience of the Republic and other foreign countries and finds that it is convenient to divide all cultural, educational, trade, medical and economic organizations into four stages in the organization of housing construction and service organizations. . In determining these stages of service organizations, the speed of participation of the population, walking distance, the minimum number of people that can be served by one organization, the profitability of organizations, service, etc. were taken into account.

Functional zoning includes: residential, kindergarten, high school, administrative and landscaped areas. Also, bus stops located in the area must be properly installed. In my project, a functional scheme was created based on these rules.



The distance between residential and public buildings is calculated on the floor of the building, which casts a shadow. In this case, each region is located within its service radius. Bus stops have been set up every 300 m and at intersections. The schools are located in the center of the district and the service radius is evenly distributed to all residential areas. Kindergartens are also located on 4 sides of the district, within the radius of their service to the entire population. The influence of the following factors on the architectural and spatial composition of the area was taken into account:

- natural and climatic;
- landscape;
- local (historical) conditions of the projected area, arising from the general plan of the city;
- methods of housing construction;
- Types of residential and public buildings, landscaping.

The service buildings were placed in a repetitive or assembled manner following the specified distances.

Below are the dimensions of the area based on the functional diagram.

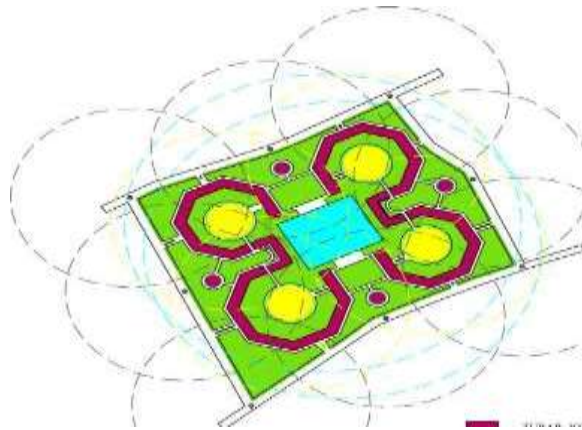

Figure 1 Functional solution Area dimensions: Total area 48 ha School 2 4.4 ha Kindergarten 4 ha 4  
Housing 5 ha

The green area is 34.6 ha  
General plan



Figure 2. Landscaping plan of the area





There will be 2 school buildings in the center of the project area. There are 4 8-sided residential complexes on 4 sides of the array. There will be a garden in the yard of each complex. There are also dwellings that connect 8-sided dwellings. They are houses with 1 porch, connected to each other. Also, near the middle of the highways, between the apartment complexes, there will be one-story houses with one entrance. Public administration and commercial facilities are mainly located on 1-2 floors of these apartments. Closed garages are located in the basement.



Figure 3. Facade plan of the area

The whole area in the area has a compact and symmetrical composition. Only the south-western part of the complex occupies a slightly larger area. Transportation of the buildings is provided from the outside of the complexes. This, in turn, ensures the safety of the population and protects the courtyard of the complex from noise.



Figure 4. Landscaping plan of the area.



Kindergartens and schools are also provided with fire safety routes. The courtyard of the complex is provided with recreation and playgrounds, sheds, sidewalks and a green area. The whole area is planted with greenery and 4 fountains in the four corners allow people to relax.

On the right and left sides of the area, outside the school area, there are sports grounds for the population, where everyone can play sports. There is also a shed near the playground, where adults can control their children. It also has a small convenience store.

Most of the accommodations are conveniently located relative to the rest of the world. In the most inconvenient parts, the parts exposed to the sun are equipped with a balcony, which prevents the rooms from overheating. The area of the massif is devoid of winding roads from one side to the other. Temporary parking is provided in front of each residence. There are also sidewalks ranging in width from 1 meter to 2.5 m.

## References

1. Madiev, Farrukh Muysinovich; Khaydarov, Shokhbozjon Zuhriddinovich; , SHAKHRISABZ CITY – ARCHITECTURAL HISTORICAL RESPONSIBILITIES, Zbiór artykułów naukowych recenzowanych., 6,28,58-61,2020, Wydawca: Sp. z o.o. «Diamond trading tour» Address wydawcy and edit: 00-728...
2. F.M.Madiev., N.Saidova, Sh.Khaydarov; , Improving traffic in Samarkand, VI International scientific-practical conference «GLOBAL SCIENCE AND INNOVATIONS 2019: CENTRAL ASIA, 1,13,71-73,2019,
3. F.M.Madiev., S.U.Rahmonkulov; , Standardization of traffic, "Scientific research results in pandemic conditions (COVID-19) Proceedings of International Multidisciplinary Conference, Part-3, Shawnee, USA", 1,1,135-139,2020,
4. F.M.Madiev., N.Saidova .; , Landscaping is a priority for development, "Scientific research results in pandemic conditions (COVID-19) Proceedings of International Multidisciplinary Conference, Part-3, Shawnee, USA", 1,3,139-142,2020,
5. F.M.Madiev .; , Measures for the development of higher education in the Republic of Uzbekistan today, International scientific-practical conference "Modern scientific solutions to current problems. Rostov-on-Don, Russia",, 140-142,2020,
6. F.M.Madiev., N.Saidova; , 4r-45 "Study of distances of cars on the 10-33 km section of the highway" Samarkand bypass ",, " Problems of architecture and construction (scientific and technical journal), ", 4,1,109-111,2020 ,